

# 1 1/16" BORE STAINLESS STEEL CYLINDER



## FSR-17-□-□

Single Acting

**Mount:** Front      **Standard Stroke Lengths:** 1/2", 1", 1-1/2", 2", 3", 4"  
**Type:** Rotating Rod      **Spring Compressed:** 7 lbs. **Spring At Rest:** 2 lbs.  
**Options:** M, B, H, V, S, N, W      **Maximum Stroke:** 27"      For M option add 0.125  
 For S option add 0.250

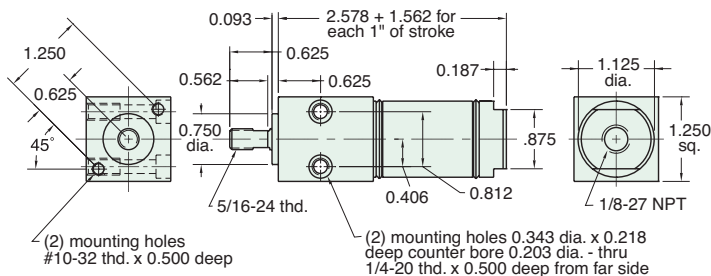

## SSN-17-□-□

Single Acting

**Mount:** Stud      **Standard Stroke Lengths:** 1/2", 1", 1-1/2", 2", 3", 4"  
**Type:** Non-Rotating Rod      **Spring Compressed:** 7 lbs. **Spring At Rest:** 2 lbs.  
**Options:** M, B, H, V, S, N      **Maximum Stroke:** 27"      For M option add 0.125  
 For S option add 0.250

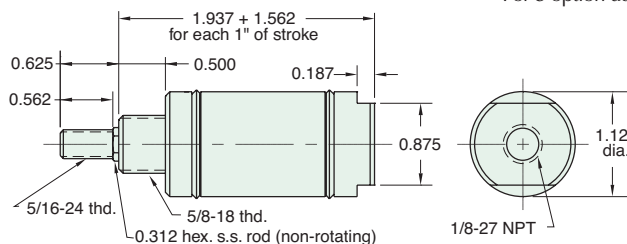

Nut included, but not shown on drawing

## SSR-17-□-□

Single Acting

**Mount:** Stud      **Standard Stroke Lengths:** 1/2", 1", 1-1/2", 2", 3", 4"  
**Type:** Rotating Rod      **Spring Compressed:** 7 lbs. **Spring At Rest:** 2 lbs.  
**Options:** M, B, H, V, S, N, W      **Maximum Stroke:** 27"      For M option add 0.125  
 For S option add 0.250

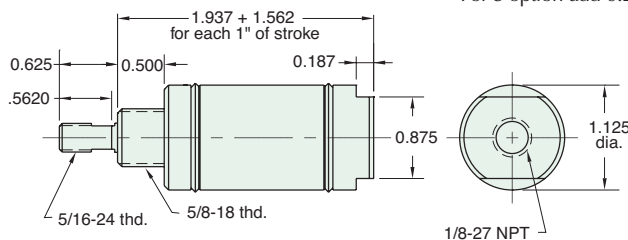

Nut included, but not shown on drawing

## TSR-17-□-□

Single Acting

**Mount:** Trunnion      **Standard Stroke Lengths:** 1/2", 1", 1-1/2", 2", 3", 4"  
**Type:** Rotating Rod      **Spring Compressed:** 7 lbs. **Spring At Rest:** 2 lbs.  
**Options:** M, B, H, V, S, N, W      **Maximum Stroke:** 26"      For M option add 0.125  
 For S option add 0.250

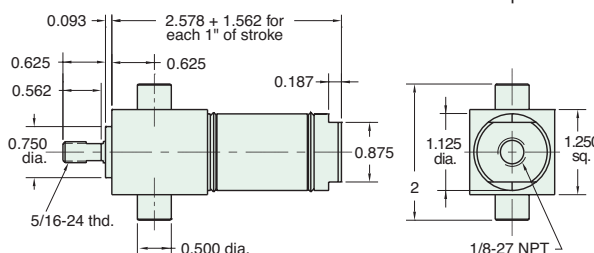



# 1 1/16" BORE STAINLESS STEEL CYLINDER

## USN-17-□-□

Single Acting



**Mount:** Universal    **Standard Stroke Lengths:** 1/2", 1", 1-1/2", 2", 3", 4"  
**Type:** Non-Rotating Rod    **Spring Compressed:** 7 lbs.    **Spring At Rest:** 2 lbs.  
**Options:** M, B, H, V, P6, N    **Maximum Stroke:** 27"    For M option add 0.125

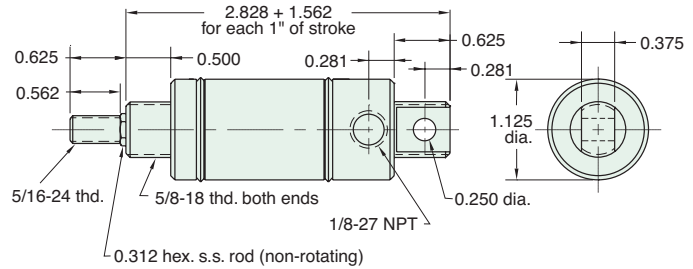

Furnished without nut(s). See Chart on Page 34.

## USR-17-□-□

Single Acting



**Mount:** Universal    **Standard Stroke Lengths:** 1/2", 1", 1-1/2", 2", 3", 4"  
**Type:** Rotating Rod    **Spring Compressed:** 7 lbs.    **Spring At Rest:** 2 lbs.  
**Options:** M, B, H, V, P6, N, W    **Maximum Stroke:** 27"    For M option add 0.125

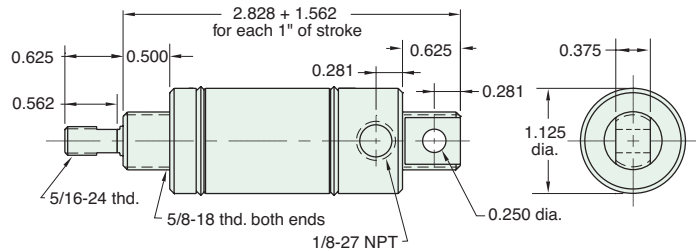

Furnished without nut(s). See Chart on Page 34.

## FDR-17-□-□

Double Acting



**Mount:** Front    **Standard Stroke Lengths:** 1/2", 1", 1-1/2", 2", 3", 4", 5", 6"  
**Type:** Rotating Rod    **Maximum Stroke:** 42"  
**Options:** M, B, W, V, P6, P7, P8, S, N    For S option add 0.250

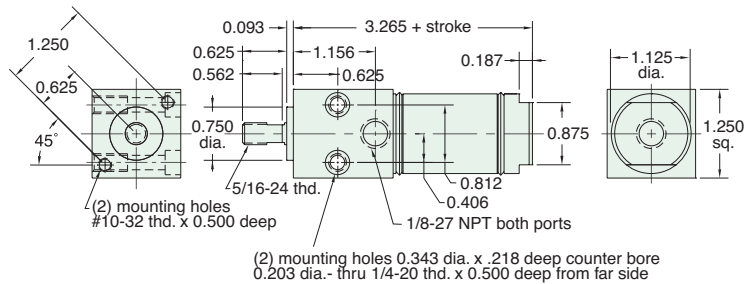

## SDR-17-□-□

Double Acting



**Mount:** Stud    **Standard Stroke Lengths:** 1/2", 1", 1-1/2", 2", 3", 4", 5", 6"  
**Type:** Rotating Rod    **Maximum Stroke:** 42"  
**Options:** C, F, R, M, B, W, V, P6, P7, P8, S, N    For C, F, R or S option add 0.250  
For CM, FM and RM add 0.562

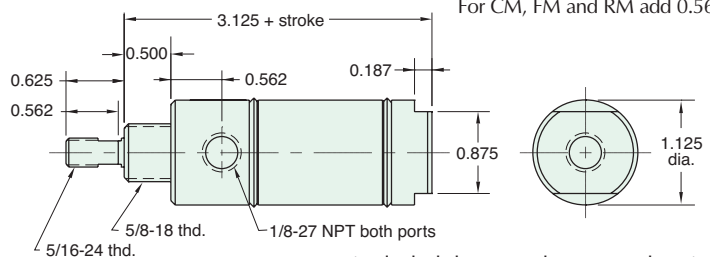

Nut included, but not shown on drawing  
For C, F, & R options use side ported rear head

# 1 1/16" BORE STAINLESS STEEL CYLINDER



## TDR-17-□-□

Double Acting



**Mount:** Trunnion **Standard Stroke Lengths:** 1/2", 1", 1-1/2", 2", 3", 4", 5", 6"  
**Type:** Rotating Rod **Maximum Stroke:** 42"  
**Options:** M, B, W, V, S, N, P6, P7, P8 For S option add 0.250

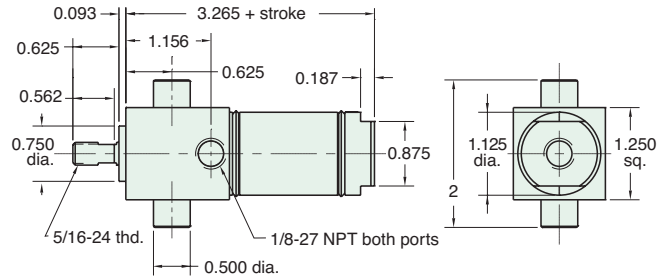

## UDR-17-□-□

Double Acting



**Mount:** Universal **Standard Stroke Lengths:** 1/2", 1", 1-1/2", 2", 3", 4", 5", 6", 8", 10", 12"  
**Type:** Rotating Rod **Maximum Stroke:** 41"  
**Options:** C, F, R, M, B, W, V, P2, P3, P4, P5, P6, P7, P8, N For CM, FM and RM add 0.312

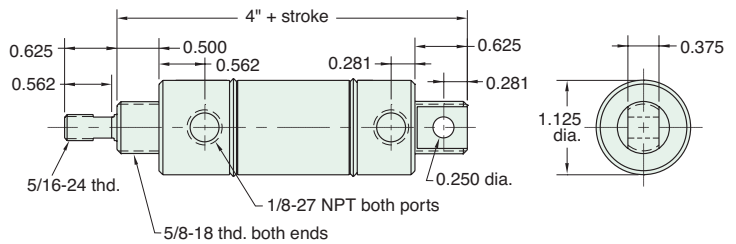

Furnished without nut(s). See Chart on Page 34.

## SDD-17-□-□

Double Acting



**Mount:** Stud **Standard Stroke Lengths:** 1", 2", 3", 4", 5", 6"  
**Type:** Double Rod **Maximum Stroke:** 20"  
**Options:** C, F, R, M, B, W, V, P6, P7, P8, N For CM, FM and RM add 0.312

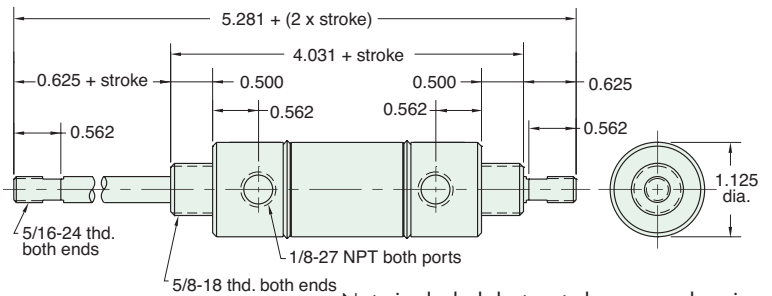

Nuts included, but not shown on drawing

## SDH-17-□-□

Double Acting



**Mount:** Stud **Standard Stroke Lengths:** 1", 2", 3", 4", 5", 6"  
**Type:** Hollow Rod **Maximum Stroke:** 20"  
**Options:** C, F, M, B, W, V, P6, P7, P8, N

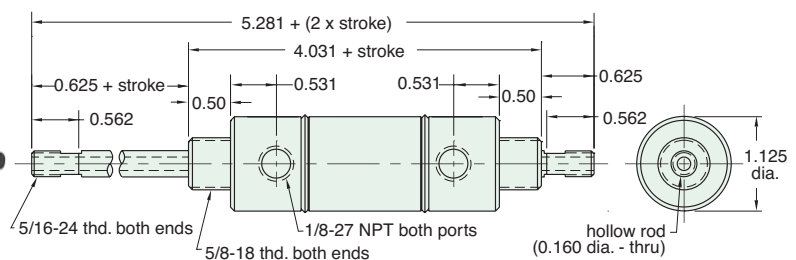

Nuts included, but not shown on drawing



# 1 1/16" BORE STAINLESS STEEL CYLINDER

## SRR-17-□-□

Reverse Acting



**Mount:** Stud      **Standard Stroke Lengths:** 1/2", 1", 1-1/2", 2", 3", 4"  
**Type:** Rotating Rod      **Spring Compressed:** 7 lbs. **Spring At Rest:** 2 lbs.  
**Options:** M, B, H, W, V, N      **Maximum Stroke:** 16"      For M option add 0.125

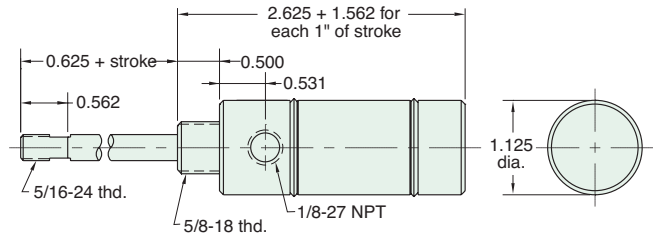

Nuts included, but not shown on drawing

## URR-17-□-□

Reverse Acting



**Mount:** Universal      **Standard Stroke Lengths:** 1/2", 1", 1-1/2", 2", 3", 4"  
**Type:** Rotating Rod      **Spring Compressed:** 7 lbs. **Spring At Rest:** 2 lbs.  
**Options:** M, B, H, W, V, P2, N      **Maximum Stroke:** 16"      For M option add 0.125

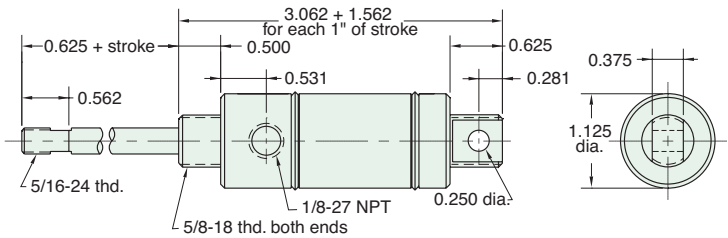

Furnished without nut(s). See Chart on Page 34.

## SFD-17-□-□

Spring Bias



**Mount:** Stud      **Standard Stroke Lengths:** 1/2", 1", 1-1/2", 2", 3", 4"  
**Type:** Double Rod      **Spring Compressed:** 7 lbs. **Spring At Rest:** 2 lbs.  
**Options:** M, B, H, W, V, P6, P7, P8, N      **Maximum Stroke:** 15"

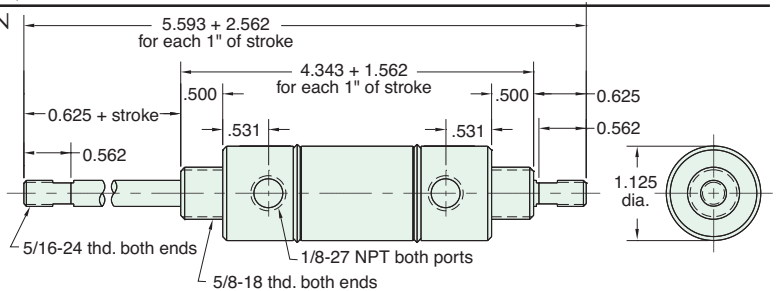

Nuts included, but not shown on drawing

## SBR-17-□-□

Double Acting Rear Spring Bias



**Mount:** Stud      **Standard Stroke Lengths:** 1/2", 1", 1-1/2", 2", 3", 4"  
**Type:** Rotating Rod      **Spring Compressed:** 7 lbs. **Spring At Rest:** 2 lbs.  
**Options:** M, B, H, W, V, P6, P7, P8, S, N      **Maximum Stroke:** 16"      For S option add 0.250

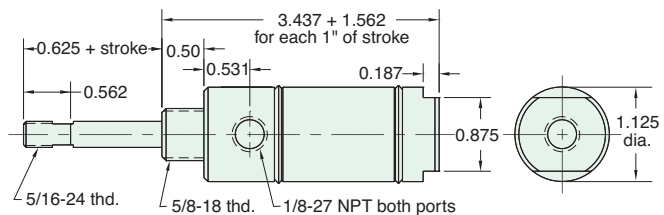

Nut included, but not shown on drawing

# 1 1/16" BORE STAINLESS STEEL CYLINDER



## SFR-17-□-□

Double Acting, Spring Bias



**Mount:** Stud  
**Type:** Rotating Rod  
**Options:** M, B, H, W, V, P6, P7, P8, S, N  
**Standard Stroke Lengths:** 1/2", 1", 1-1/2", 2", 3", 4"  
**Spring Compressed:** 7 lbs. **Spring At Rest:** 2 lbs.  
**Maximum Stroke:** 26"  
 For S option add 0.250

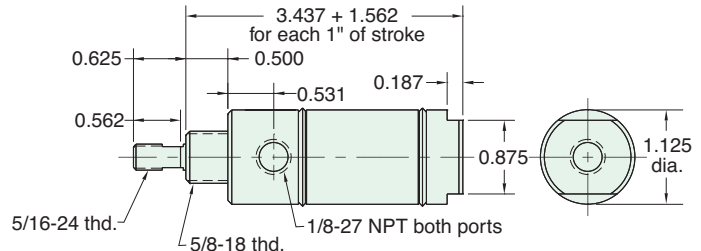

Nut included, but not shown on drawing

## UBR-17-□-□

Double Acting, Rear Spring Bias



**Mount:** Universal  
**Type:** Rotating Rod  
**Options:** M, B, H, W, V, P2, P3, P4, P5, P6, P7, P8, N  
**Standard Stroke Lengths:** 1/2", 1", 1-1/2", 2", 3", 4"  
**Spring Compressed:** 7 lbs. **Spring At Rest:** 2 lbs.  
**Maximum Stroke:** 16"

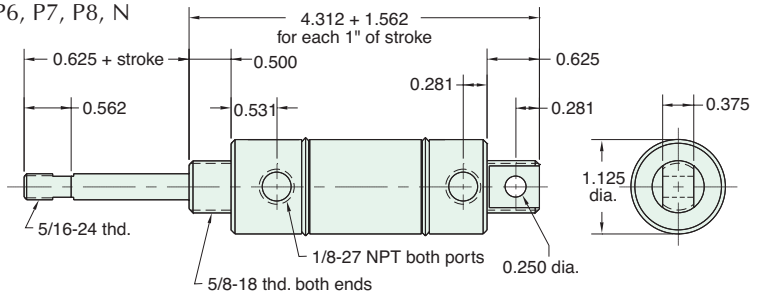

Furnished without nut(s). See Chart on Page 34.

## UFR-17-□-□

Double Acting Front Spring Bias



**Mount:** Universal  
**Type:** Rotating Rod  
**Options:** M, B, H, W, V, P2, P3, P4, P5, P6, P7, P8, N  
**Standard Stroke Lengths:** 1/2", 1", 1-1/2", 2", 3", 4"  
**Spring Compressed:** 7 lbs. **Spring At Rest:** 2 lbs.  
**Maximum Stroke:** 26"

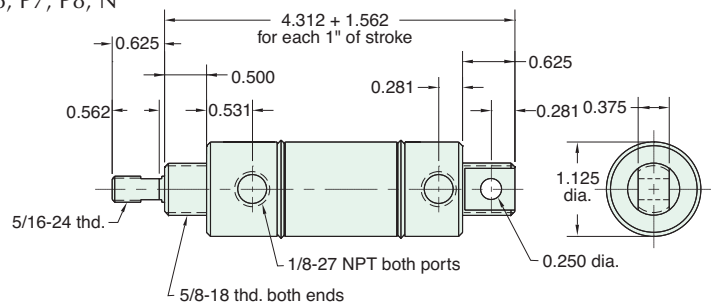

Furnished without nut(s). See Chart on Page 34.



# 1 1/16" BORE ACCESSORIES



## CB-1795

Clevis Bracket  
Material: Steel, bright zinc plated

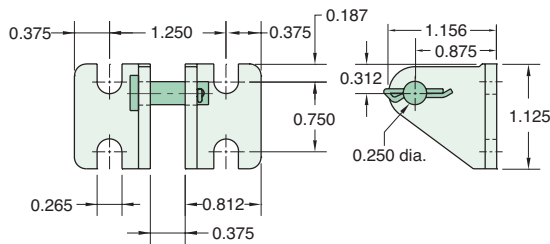

## RC-1781

Rod Clevis  
Material: Steel, electroless nickel plate

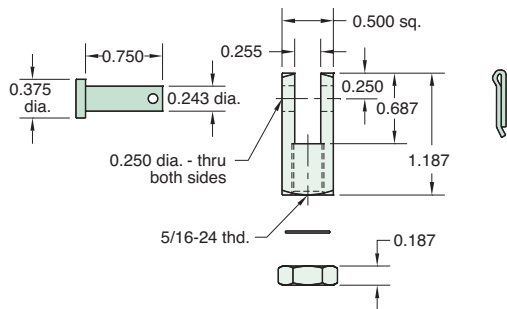

## FB-1791

Foot Bracket  
Material: Steel, bright zinc plated

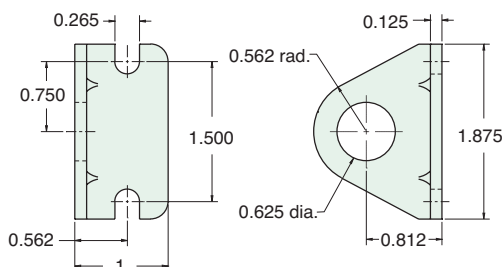

## MOUNTING NUTS

### Stud Nut

Part Number	Across Flats	Nut Thickness	Nut (Thread)
N10-18	15/16"	3/8"	5/8-18

### Rod Nut

Part Number	Across Flats	Nut Thickness	Nut (Thread)
N05-24	1/2"	3/16"	5/16-24

## RE-1785

Rod End  
Material: Steel, bright zinc plated body

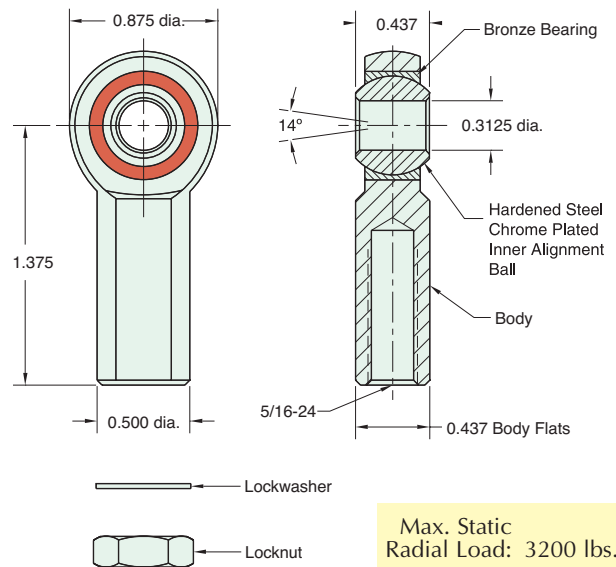

Max. Static Radial Load: 3200 lbs.  
Fits Rod Thread Size: 5/16-24