

1 1/2" BORE STAINLESS STEEL CYLINDER



CSN-24-□-□

Single Acting



Mount: Clevis **Standard Stroke Lengths:** 1/2", 1", 1-1/2", 2", 3", 4"
Type: Non-Rotating Rod **Spring Compressed:** 10 lbs. **Spring At Rest:** 4 1/2 lbs.
Options: M, B, H, V, P6, N **Maximum Stroke:** 24" For M option add 0.125

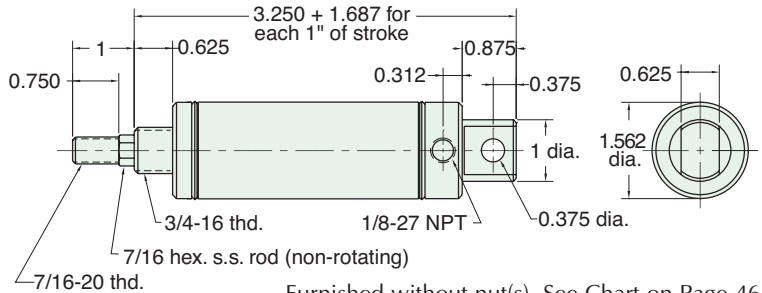

Furnished without nut(s). See Chart on Page 46.

CSR-24-□-□

Single Acting



Mount: Clevis **Standard Stroke Lengths:** 1/2", 1", 1-1/2", 2", 3", 4"
Type: Rotating Rod **Spring Compressed:** 10 lbs. **Spring At Rest:** 4 1/2 lbs.
Options: M, B, H, V, P6, N, W **Maximum Stroke:** 24" For M option add 0.125

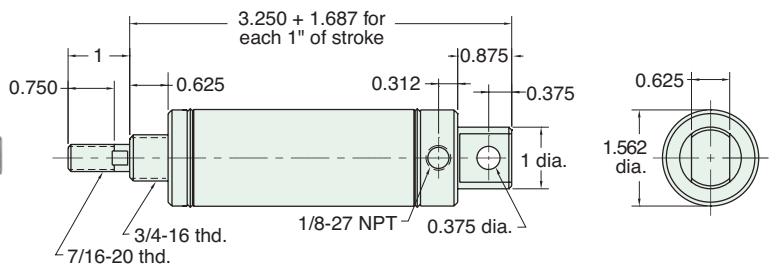

Furnished without nut(s). See Chart on Page 46.

ESN-24-□-□

Single Acting



Mount: End **Standard Stroke Lengths:** 1/2", 1", 1-1/2", 2", 3", 4"
Type: Non-Rotating Rod **Spring Compressed:** 10 lbs. **Spring At Rest:** 4 1/2 lbs.
Options: M, B, H, V, N **Maximum Stroke:** 24" For M option add 0.125

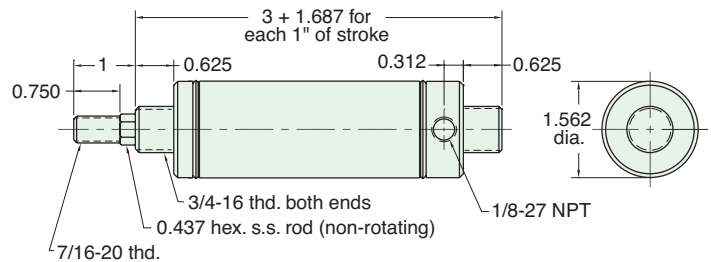

Nuts included, but not shown on drawing

ESR-24-□-□

Single Acting



Mount: End **Standard Stroke Lengths:** 1/2", 1", 1-1/2", 2", 3", 4"
Type: Rotating Rod **Spring Compressed:** 10 lbs. **Spring At Rest:** 4 1/2 lbs.
Options: M, B, H, V, N, W **Maximum Stroke:** 15" For M option add 0.125

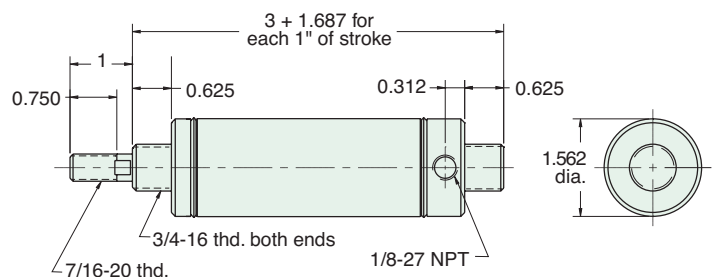

Nut included, but not shown on drawing



1 1/2" BORE STAINLESS STEEL CYLINDER

FSR-24-□-□

Single Acting

Mount: Front **Standard Stroke Lengths:** 1/2", 1", 1-1/2", 2", 3", 4"
Type: Rotating Rod **Spring Compressed:** 10 lbs. **Spring At Rest:** 4 1/2 lbs.
Options: M, B, H, V, S, N, W **Maximum Stroke:** 24" For M option add 0.125
For S option add 0.187

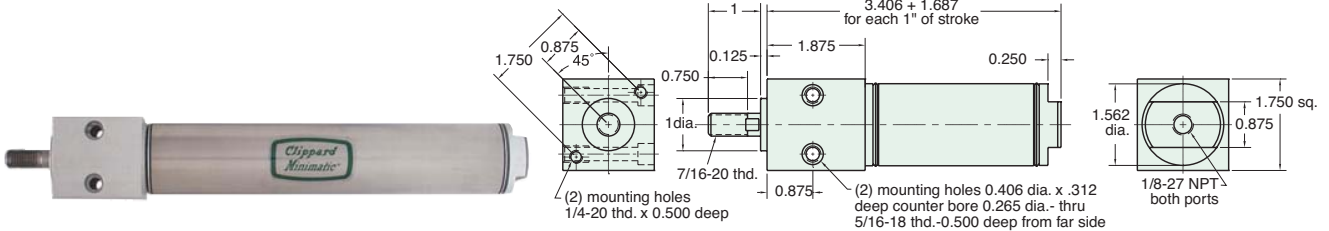

SSN-24-□-□

Single Acting

Mount: Stud **Standard Stroke Lengths:** 1/2", 1", 1-1/2", 2", 3", 4"
Type: Non-Rotating Rod **Spring Compressed:** 10 lbs. **Spring At Rest:** 4 1/2 lbs.
Options: M, B, H, V, S, N **Maximum Stroke:** 24" For M option add 0.125
For S option add 0.187

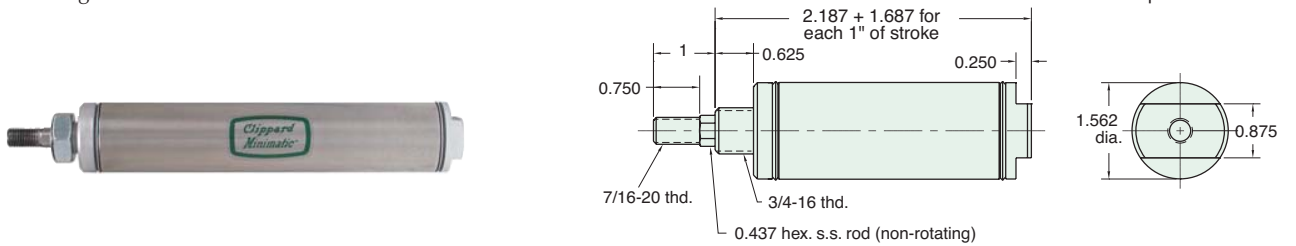

Nut included, but not shown on drawing

SSR-24-□-□

Single Acting

Mount: Stud **Standard Stroke Lengths:** 1/2", 1", 1-1/2", 2", 3", 4"
Type: Rotating Rod **Spring Compressed:** 10 lbs. **Spring At Rest:** 4 1/2 lbs.
Options: M, B, H, V, S, N, W **Maximum Stroke:** 24" For M option add 0.125
For S option add 0.187

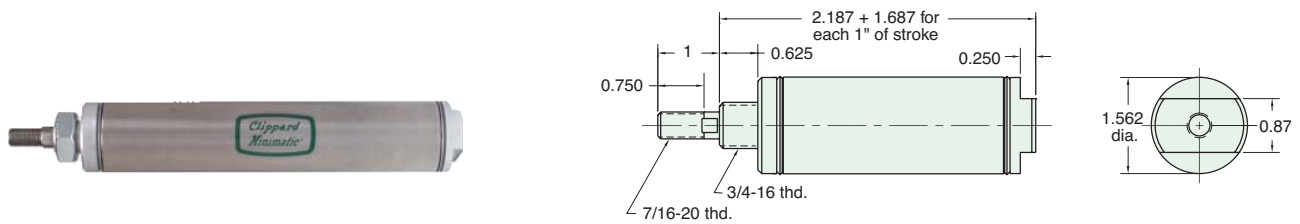

Nut included, but not shown on drawing

TSR-24-□-□

Single Acting

Mount: Trunnion **Standard Stroke Lengths:** 1/2", 1", 1-1/2", 2", 3", 4"
Type: Rotating Rod **Spring Compressed:** 10 lbs. **Spring At Rest:** 4 1/2 lbs.
Options: M, B, H, V, S, N, W **Maximum Stroke:** 23" For M option add 0.125
For S option add 0.187

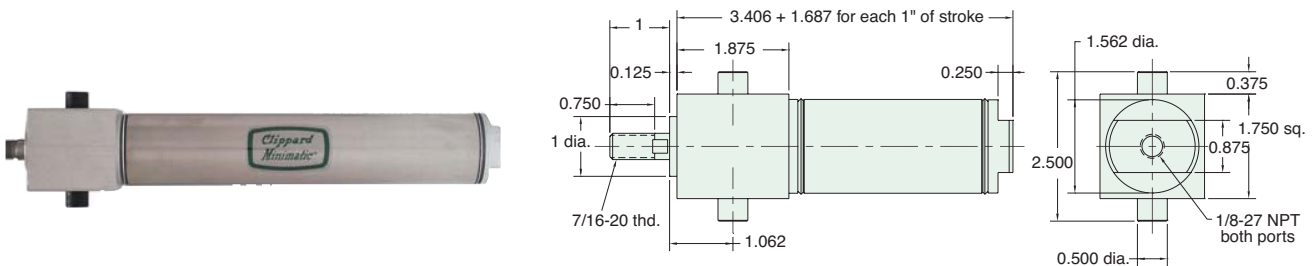

1 1/2" BORE STAINLESS STEEL CYLINDER



CDR-24-□-□

Double Acting



Mount: Clevis **Standard Stroke Lengths:** 1/2", 1", 1-1/2", 2", 3", 4", 6", 8", 10", 12"
Type: Rotating Rod **Maximum Stroke:** 39"
Options: C, F, R, M, B, W, V, P2, P3, P4, P5, P6, P7, P8, N

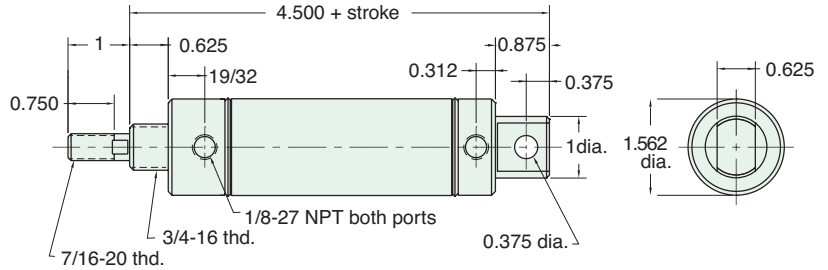

Furnished without nut(s). See Chart on Page 46.

EDR-24-□-□

Double Acting



Mount: End **Standard Stroke Lengths:** 1/2", 1", 1-1/2", 2", 3", 4", 6", 8", 10", 12"
Type: Rotating Rod **Maximum Stroke:** 39"
Options: C, F, R, M, B, W, V, P6, P7, P8, N

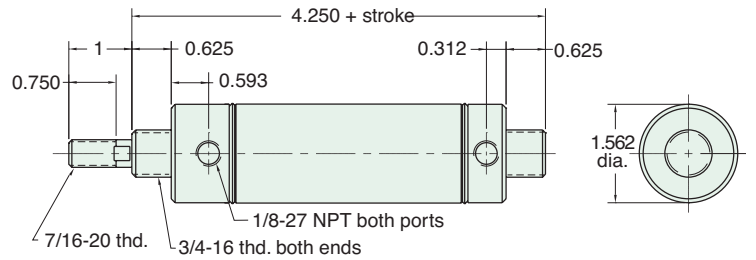

Nuts included, but not shown on drawing

FDR-24-□-□

Double Acting



Mount: Front **Standard Stroke Lengths:** 1/2", 1", 1-1/2", 2", 3", 4", 5", 6"
Type: Rotating Rod **Maximum Stroke:** 40"
Options: M, B, W, V, P6, P7, P8, S, N For S option add 0.187

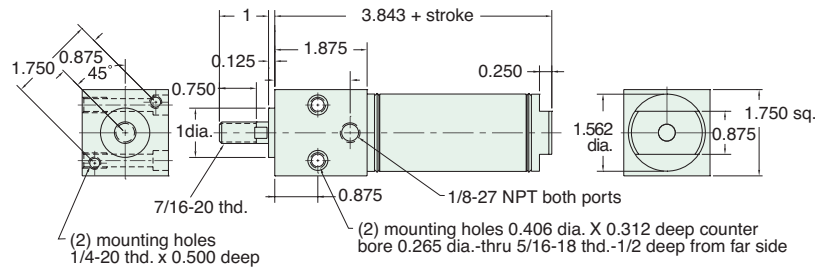

SDR-24-□-□

Double Acting



Mount: Stud **Standard Stroke Lengths:** 1/2", 1", 1-1/2", 2", 3", 4", 6", 8", 10", 12"
Type: Rotating Rod **Maximum Stroke:** 40"
Options: C, F, R, M, B, W, V, P6, P7, P8, S, N For C, F, R and S option add 0.187

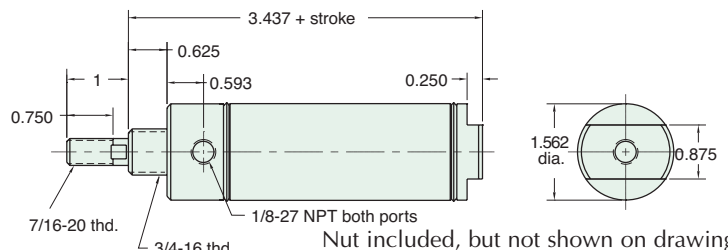

Nut included, but not shown on drawing
 For C, F, & R options use side ported rear head



1 1/2" BORE STAINLESS STEEL CYLINDER

TDR-24-□-□

Double Acting



Mount: Trunnion **Standard Stroke Lengths:** 1/2", 1", 1-1/2", 2", 3", 4", 5", 6"

Type: Rotating Rod **Maximum Stroke:** 40"

Options: M, B, W, V, S, N
P6, P7, P8

For S option add 0.187

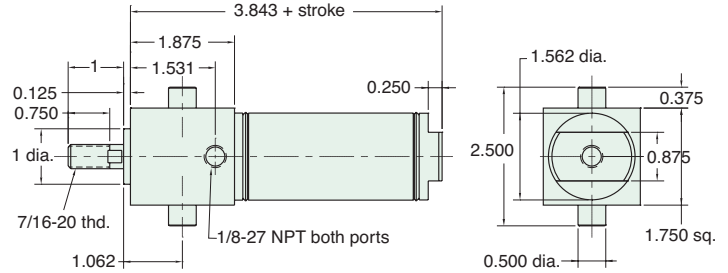

SDD-24-□-□

Double Acting



Mount: Stud **Standard Stroke Lengths:** 1", 2", 3", 4", 5", 6", 8", 10", 12"

Type: Double Rod **Maximum Stroke:** 19"

Options: C, F, M, B, W, V, P6, P7, P8, N

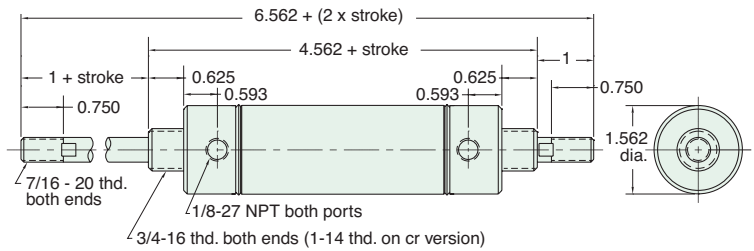

Nuts included, but not shown on drawing

CRR-24-□-□

Reverse Acting



Mount: Clevis **Standard Stroke Lengths:** 1/2", 1", 1-1/2", 2", 3", 4"

Type: Rotating Rod **Spring Compressed:** 10 lbs. **Spring At Rest:** 4 1/2 lbs.

Options: M, B, H, W, V, P2, P3, P4, P5, P6, P7, P8, N
Maximum Stroke: 14"

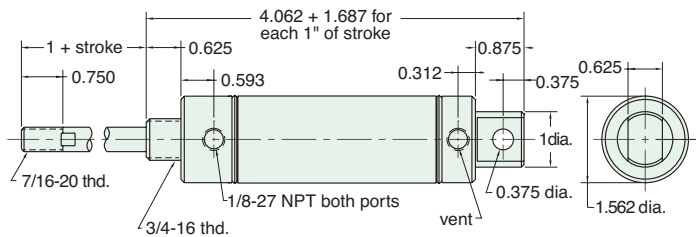

Furnished without nut(s). See Chart on Page 46.

ERR-24-□-□

Reverse Acting



Mount: End **Standard Stroke Lengths:** 1/2", 1", 1-1/2", 2", 3", 4"

Type: Rotating Rod **Spring Compressed:** 10 lbs. **Spring At Rest:** 4 1/2 lbs.

Options: M, B, H, W, V, N
Maximum Stroke: 14"

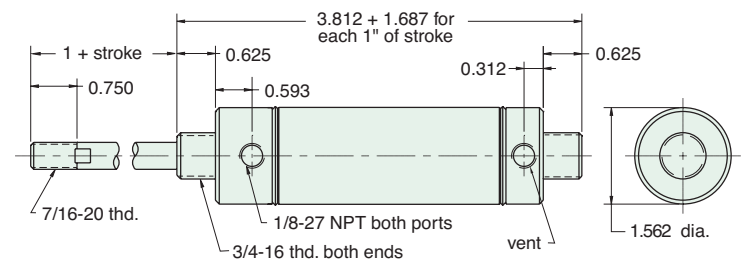

Nuts included, but not shown on drawing

1 1/2" BORE STAINLESS STEEL CYLINDER



FRR-24-□-□

Reverse Acting

Mount: Front **Standard Stroke Lengths:** 1/2", 1", 1-1/2", 2", 3", 4"
Type: Rotating Rod **Spring Compressed:** 10 lbs. **Spring At Rest:** 4 1/2 lbs.
Options: M, B, H, W, V, N **Maximum Stroke:** 15"

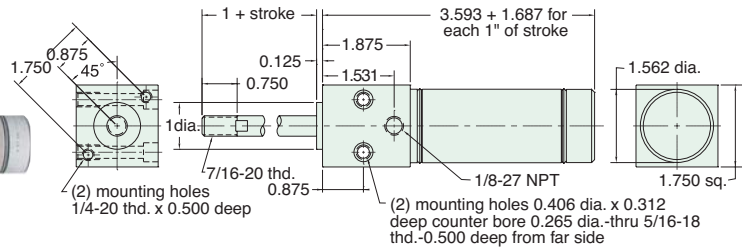

SRR-24-□-□

Reverse Acting

Mount: Stud **Standard Stroke Lengths:** 1/2", 1", 1-1/2", 2", 3", 4"
Type: Rotating Rod **Spring Compressed:** 10 lbs. **Spring At Rest:** 4 1/2 lbs.
Options: M, B, H, W, V, N **Maximum Stroke:** 15"

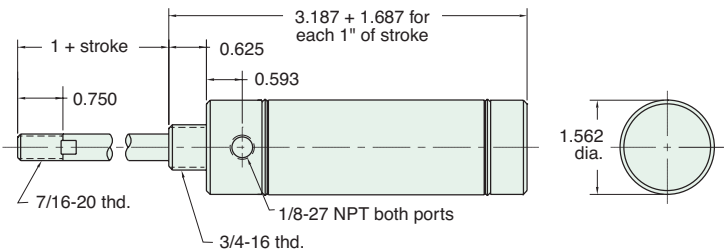

Nut included, but not shown on drawing

CBR-24-□-□

Double Acting, Spring Bias

Mount: Clevis **Standard Stroke Lengths:** 1/2", 1", 1-1/2", 2", 3", 4"
Type: Rotating Rod **Spring Compressed:** 10 lbs. **Spring At Rest:** 4 1/2 lbs.
Options: M, B, H, W, V, P2, P3, P4, P5, P6, P7, P8, N **Maximum Stroke:** 14"

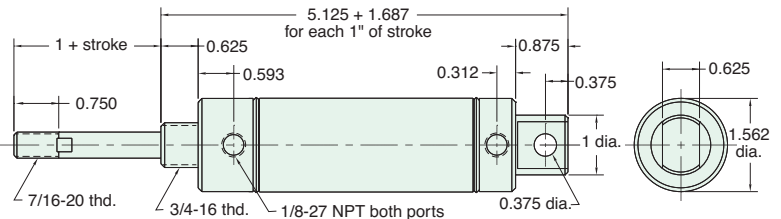

Furnished without nut(s). See Chart on Page 46.

CFR-24-□-□

Double Acting, Front Spring Bias

Mount: Clevis **Standard Stroke Lengths:** 1/2", 1", 1-1/2", 2", 3", 4"
Type: Rotating Rod **Spring Compressed:** 10 lbs. **Spring At Rest:** 4 1/2 lbs.
Options: M, B, H, W, V, P2, P3, P4, P5, P6, P7, P8, N **Maximum Stroke:** 23"

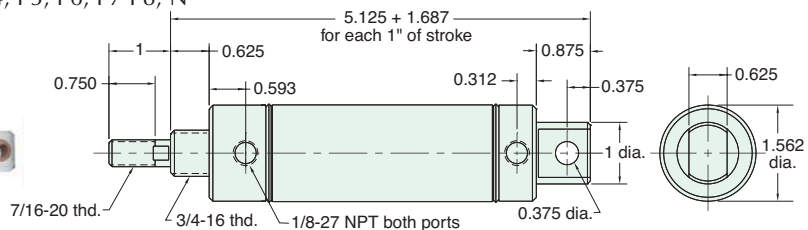

Furnished without nut(s). See Chart on Page 46.



1 1/2" BORE STAINLESS STEEL CYLINDER

EBR-24-□-□

Double Acting, Rear Spring Bias



Mount: End **Standard Stroke Lengths:** 1/2", 1", 1-1/2", 2", 3", 4"
Type: Rotating Rod **Spring Compressed:** 10 lbs. **Spring At Rest:** 4 1/2 lbs.
Options: M, B, H, W, V, **Maximum Stroke:** 14"
P6, P7, P8, N

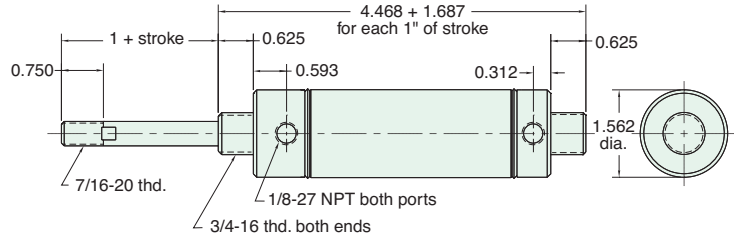

Nuts included, but not shown on drawing

EFR-24-□-□

Double Acting, Front Spring Bias



Mount: End **Standard Stroke Lengths:** 1/2", 1", 1-1/2", 2", 3", 4"
Type: Rotating Rod **Spring Compressed:** 10 lbs. **Spring At Rest:** 4 1/2 lbs.
Options: M, B, H, W, V, **Maximum Stroke:** 23"
P6, P7, P8, N

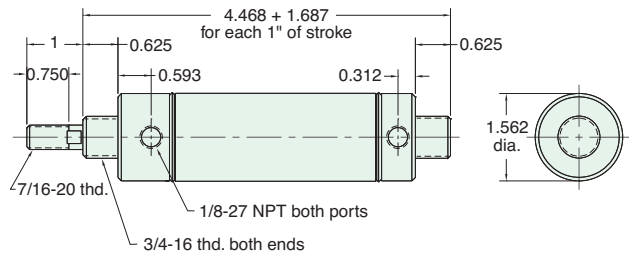

Nuts included, but not shown on drawing

SFD-24-□-□

Double Acting, Front Spring Bias



Mount: Stud **Standard Stroke Lengths:** 1/2", 1", 1-1/2", 2", 3", 4"
Type: Double Rod **Spring Compressed:** 10 lbs. **Spring At Rest:** 4 1/2 lbs.
Options: M, B, H, W, V, **Maximum Stroke:** 14"
V, P6, P7, P8, N

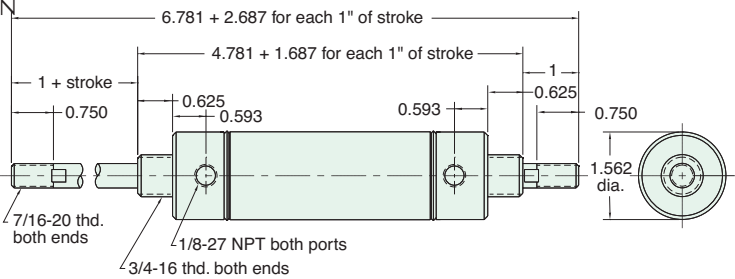

Nuts included, but not shown on drawing

SBR-24-□-□

Double Acting, Rear Spring Bias



Mount: Stud **Standard Stroke Lengths:** 1/2", 1", 1-1/2", 2", 3", 4"
Type: Rotating Rod **Spring Compressed:** 10 lbs. **Spring At Rest:** 4 1/2 lbs.
Options: M, B, H, W, V, **Maximum Stroke:** 15"
P6, P7, P8, S, N For S option add 0.187

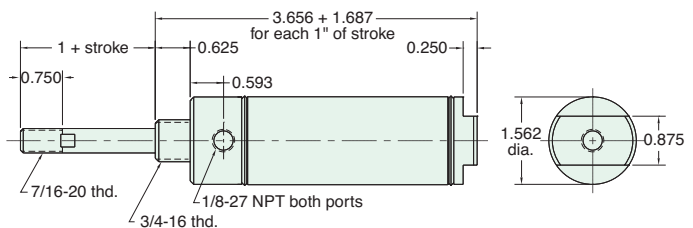

Nuts included, but not shown on drawing

1 1/2" BORE STAINLESS STEEL CYLINDER



SFR-24-□-□

Double Acting, Front Spring Bias

Mount: Stud **Standard Stroke Lengths:** 1/2", 1", 1-1/2", 2", 3", 4"
Type: Rotating Rod **Spring Compressed:** 10 lbs. **Spring At Rest:** 4 1/2 lbs.
Options: M, B, H, W, V, P6, **Maximum Stroke:** 23" For S option add 0.187
 P7, P8, S, N

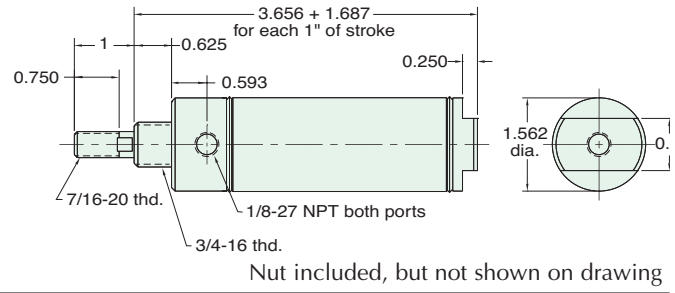

Pneumatic Stapler

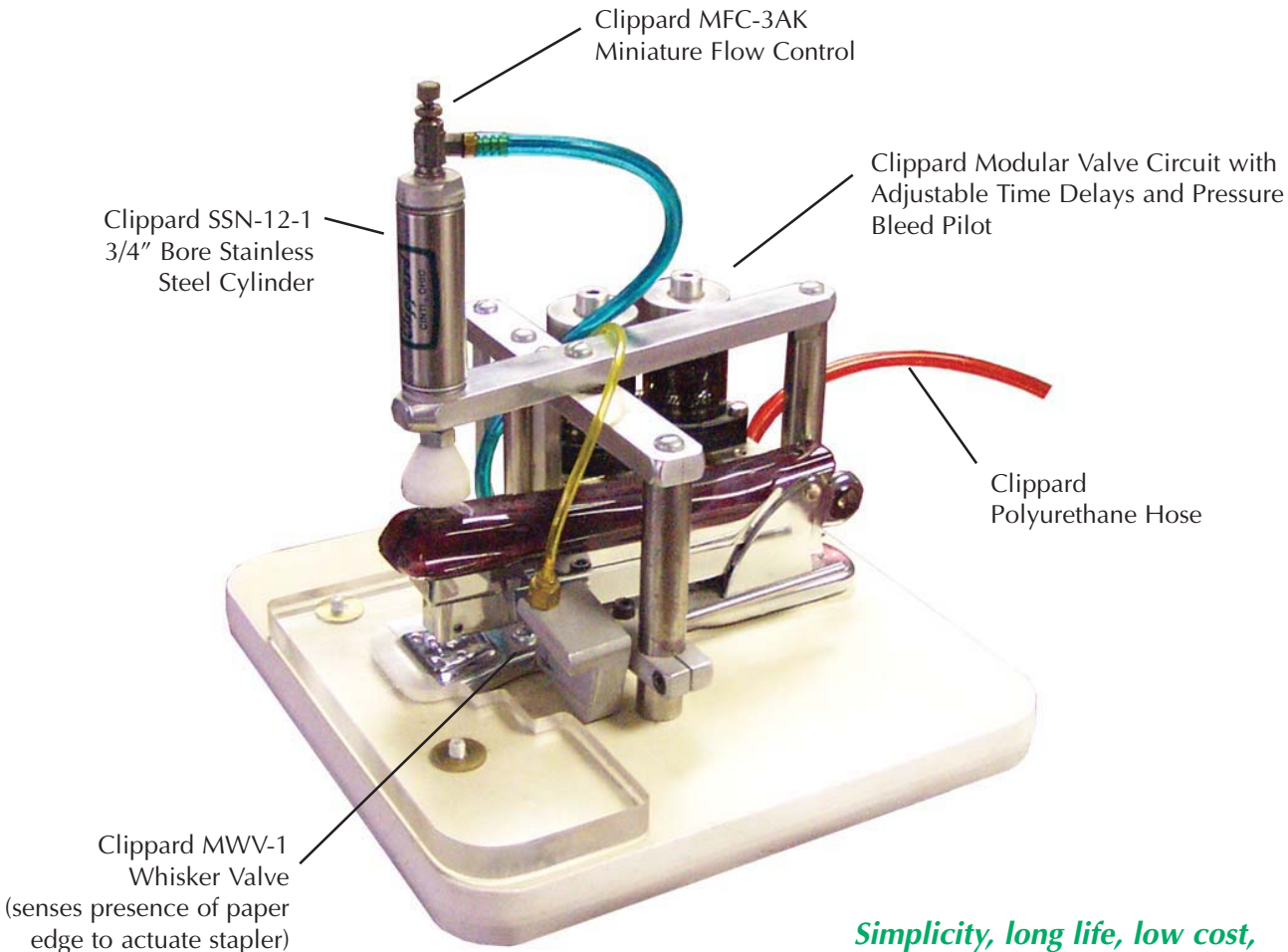

Simplicity, long life, low cost, ease of maintenance and high power are combined in this unique office stapler application.



1 1/2" BORE ACCESSORIES



MOUNTING NUTS

Stud Nut

Part Number	Across Flats	Nut Thickness	Nut (Thread)
N12-16	1 3/32"	27/64"	3/4-16

Rod Nut

Part Number	Across Flats	Nut Thickness	Nut (Thread)
N07-20	11/16"	1/4"	7/16-20

CB-2495

Clevis Bracket
Material: Steel, bright zinc plated

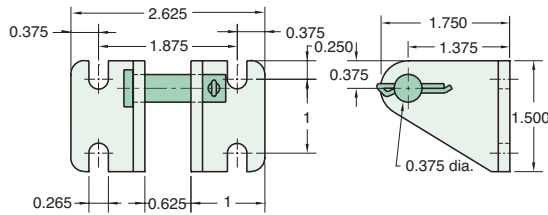

RE-2485

Rod End
Material: Steel, bright zinc plated body

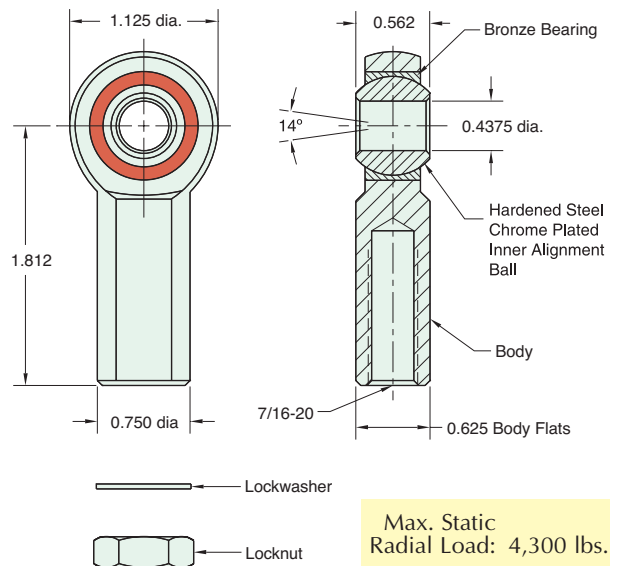

Max. Static Radial Load: 4,300 lbs.
Fits Rod Thread Size: 7/16-20

RC-2481

Rod Clevis
Material: Steel, electroless nickel plate

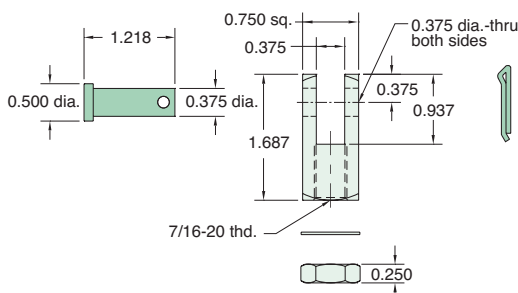

FB-2491

Foot Bracket
Material: Steel, bright zinc plated

