

2" BORE STAINLESS STEEL CYLINDER



SSR-32-□-□

Single Acting



Mount: Stud **Standard Stroke Lengths:** 1", 2", 3", 4", 5", 6", 7", 8", 10", 12"
Type: Rotating Rod **Spring Compressed:** 30 lbs. **Spring At Rest:** 15 lbs.
Options: M, B, V, S, N, W **Maximum Stroke:** 20"
 For M option add 0.125
 For S option add 0.375

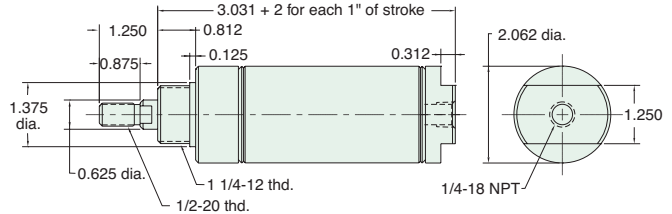

Nut included, but not shown on drawing

USR-32-□-□

Single Acting



Mount: Universal **Standard Stroke Lengths:** 1/2", 1", 1-1/2", 2", 3", 4"
Type: Rotating Rod **Spring Compressed:** 30 lbs. **Spring At Rest:** 15 lbs.
Options: M, B, V, N, P6, W **Maximum Stroke:** 19"
 For M option add 0.125

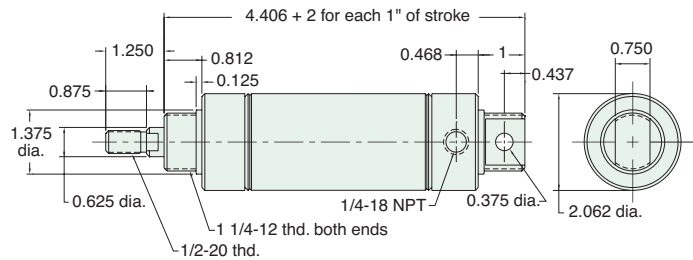

Furnished without nut(s). See Chart on Page 54.

SDR-32-□-□

Double Acting



Mount: Stud **Standard Stroke Lengths:** 1/2", 1", 1-1/2", 2", 3", 4", 5", 6"
Type: Rotating Rod **Maximum Stroke:** 39"
Options: C, F, R, M, B, W, V, P6, P7, P8, S, N **For C, F, R and S options add 0.375**

For S option add .375

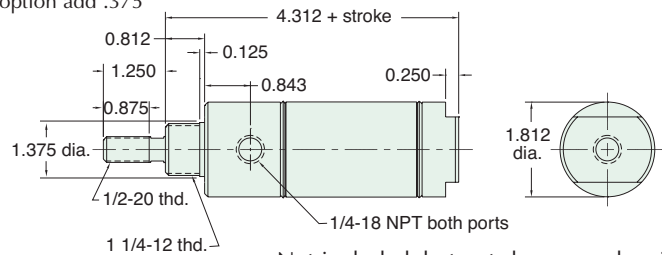

Nut included, but not shown on drawing

For C, F, & R options use side ported rear head

UDR-32-□-□

Double Acting



Mount: Universal **Standard Stroke Lengths:** 1/2", 1", 1-1/2", 2", 3", 4", 5", 6", 7", 8", 10", 12"
Type: Rotating Rod **Maximum Stroke:** 38"
Options: C, F, R, M, B, W, V, P2, P3, P4, P5, P6, P7, P8, N

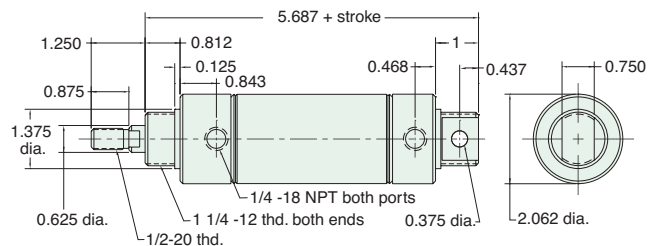

Furnished without nut(s). See Chart on Page 54.



2" BORE STAINLESS STEEL CYLINDER

SDD-32-□-□

Double Acting

Mount: Stud **Standard Stroke Lengths:** 1", 2", 3", 4", 5", 6", 8", 10", 12"
Type: Double Rod **Maximum Stroke:** 18"
Options: C, F, M, B, W, V, P6, P7, P8, N

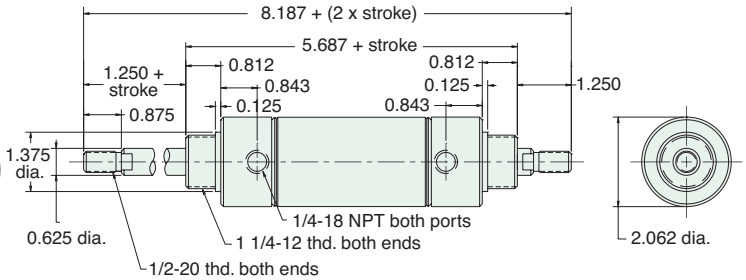

Nuts included, but not shown on drawing

SRR-32-□-□

Reverse Acting

Mount: Stud **Standard Stroke Lengths:** 1", 2", 3", 4", 5", 6"
Type: Rotating Rod **Spring Compressed:** 30 lbs. **Spring At Rest:** 15 lbs.
Options: M, B, W, V, N **Maximum Stroke:** 12" For M option add 0.125

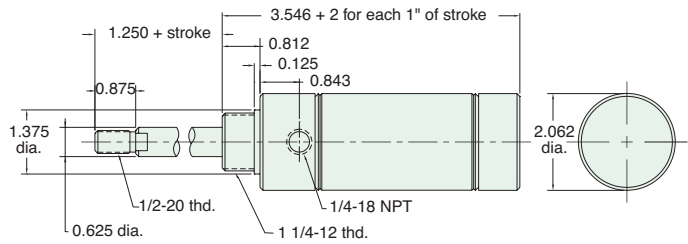

Nut included, but not shown on drawing

URR-32-□-□

Reverse Acting

Mount: Universal **Standard Stroke Lengths:** 1/2", 1", 1-1/2", 2", 3", 4"
Type: Rotating Rod **Spring Compressed:** 30 lbs. **Spring At Rest:** 15 lbs.
Options: M, B, W, V, P2, N **Maximum Stroke:** 13" For M option add 0.125

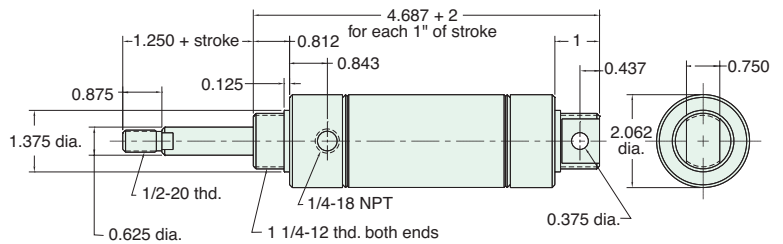

Furnished without nut(s). See Chart on Page 54.

SFR-32-□-□

Spring Bias

Mount: Stud **Standard Stroke Lengths:** 1/2", 1", 1-1/2", 2", 3", 4"
Type: Rotating Rod **Spring Compressed:** 30 lbs. **Spring At Rest:** 15 lbs.
Options: M, B, W, V, P6, P7, P8, S, N For S option add 0.375

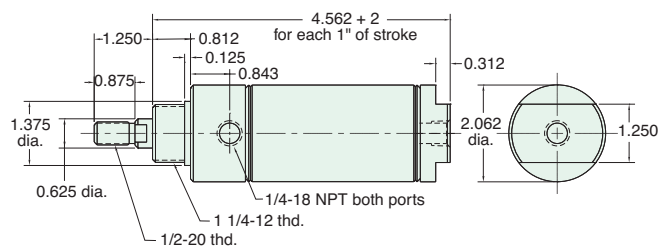

Nut included, but not shown on drawing

2" BORE STAINLESS STEEL CYLINDER



SBR-32-□-□

Spring Bias

Mount: Stud **Standard Stroke Lengths:** 1/2", 1", 1-1/2", 2", 3", 4"
Type: Rotating Rod **Spring Compressed:** 30 lbs. **Spring At Rest:** 15 lbs.
Options: M, B, W, V, P6, P7, P8, S, N For S option add 0.375

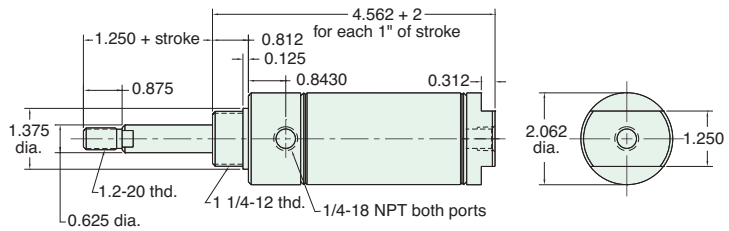

Nut included, but not shown on drawing

UFR-32-□-□

Spring Bias

Mount: Universal **Standard Stroke Lengths:** 1/2", 1", 1-1/2", 2", 3", 4"
Type: Rotating Rod **Spring Compressed:** 30 lbs. **Spring At Rest:** 15 lbs.
Options: M, B, W, V, P2, P3, P4, P5, P6, P7, P8, N

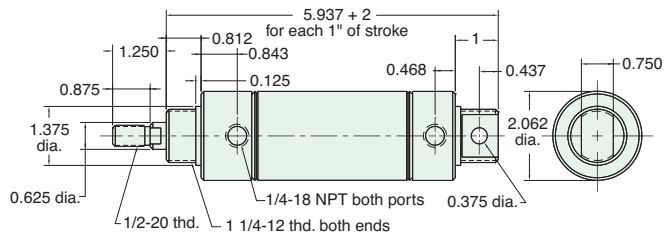

Furnished without nut(s). See Chart on Page 54.

UBR-32-□-□

Spring Bias

Mount: Universal **Standard Stroke Lengths:** 1/2", 1", 1-1/2", 2", 3", 4"
Type: Rotating Rod **Spring Compressed:** 30 lbs. **Spring At Rest:** 15 lbs.
Options: M, B, W, V, P2, P3, P4, P5, P6, P7, P8, N

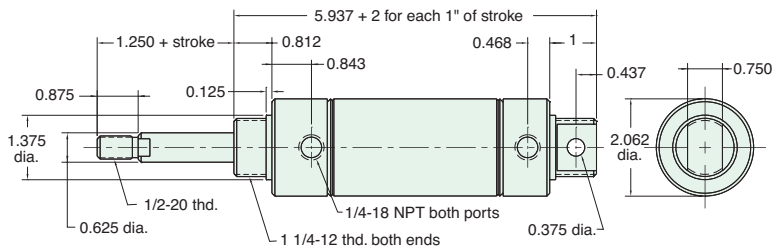

Furnished without nut(s). See Chart on Page 54.

Did you know that all Clippard Cylinders are 100% tested.



2" BORE ACCESSORIES



CB-3295

Clevis Bracket
Material: Steel, bright zinc plated

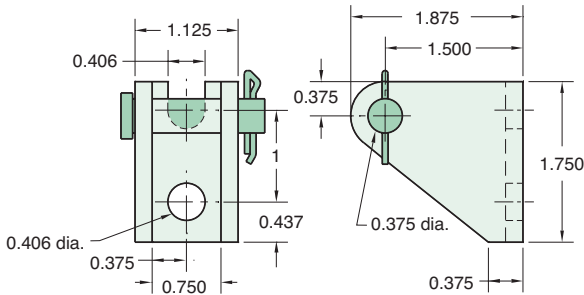

RC-3281

Rod Clevis
Material: Steel, electroless nickel plate

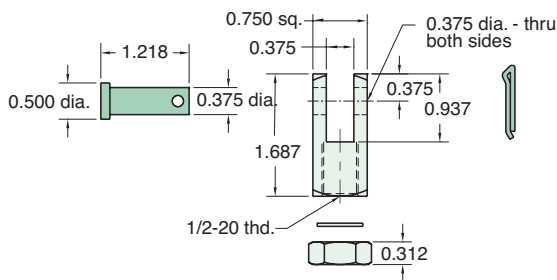

FB-3291

Foot Bracket
Material: Steel, bright zinc plated

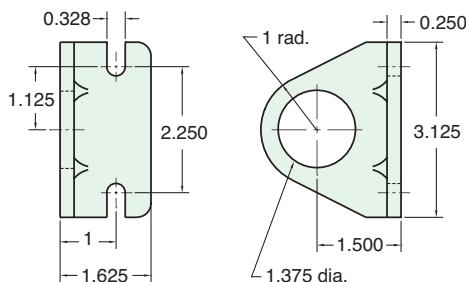

MOUNTING NUTS

Stud Nut

Part Number	Across Flats	Nut Thickness	Nut (Thread)
N20-12	1 3/4"	7/16"	1 1/4-12

Rod Nut

Part Number	Across Flats	Nut Thickness	Nut (Thread)
N08-20	3/4"	5/16"	1/2-20

RK-3299

Replaceable Rod Seal
Material: Aluminum body

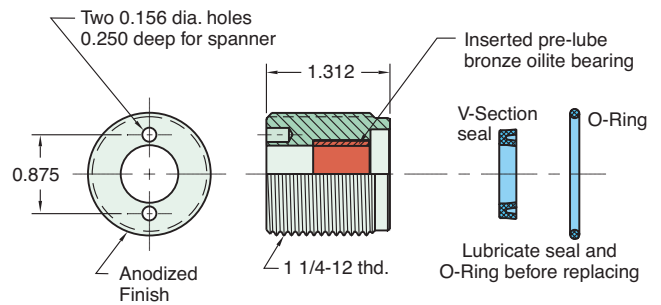

RE-3285

Rod End
Material: Steel, bright zinc plated body

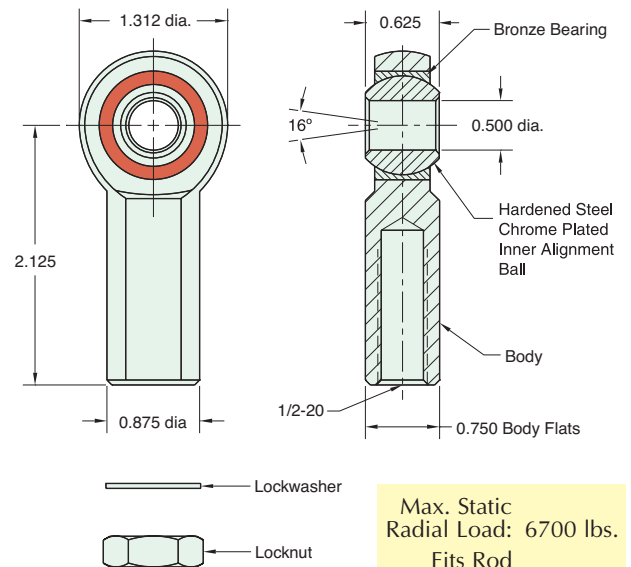

Max. Static Radial Load: 6700 lbs.
Fits Rod Thread Size: 1/2-20