



5/16" BORE STAINLESS STEEL CYLINDER

SSR-05-□-□

Single Acting

Mount: Stud
Type: Rotating Rod
Options: B, V, S, N

Standard Stroke Lengths: 1/2", 1", 1-1/2", 2", 3", 4"
Spring Compressed: 1 lbs. **Spring At Rest:** 0.5 lbs.
Maximum Stroke: 29"

For B option add 0.250
For S option add 0.220

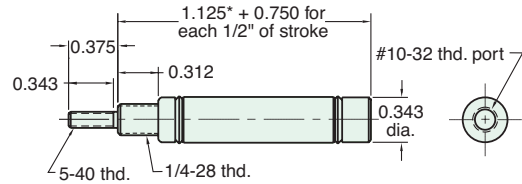

Nut included, but not shown on drawing

USR-05-□-□

Single Acting

Mount: Universal
Type: Rotating Rod
Options: B, V, N, P6

Standard Stroke Lengths: 1/2", 1", 1-1/2", 2", 3", 4"
Spring Compressed: 1 lbs. **Spring At Rest:** 0.5 lbs.
Maximum Stroke: 29"

For B option add 0.250

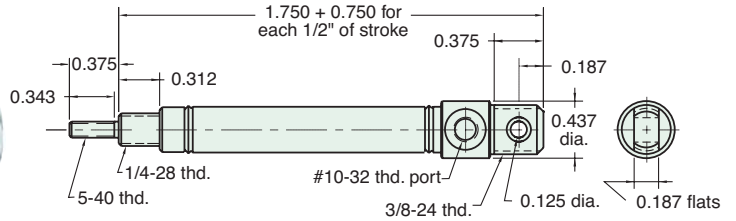

Nuts included, but not shown on drawing

SDR-05-□-□

Double Acting

Mount: Stud
Type: Rotating Rod
Options: B, V, P6, P7, P8, S, N

Standard Stroke Lengths: 1/2", 1", 1-1/2", 2", 3", 4"
Maximum Stroke: 43"

For B option add 0.250
For S option add 0.220

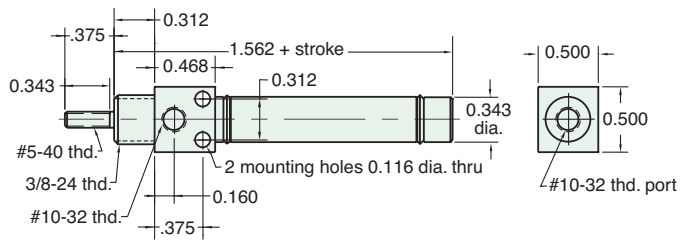

Nut included, but not shown on drawing

UDR-05-□-□

Double Acting

Mount: Universal
Type: Rotating Rod
Options: B, V, P2, P3, P4, P5, P6, P7, P8, N

Standard Stroke Lengths: 1/2", 1", 1-1/2", 2", 3", 4"
Maximum Stroke: 43"

For B option add 0.250

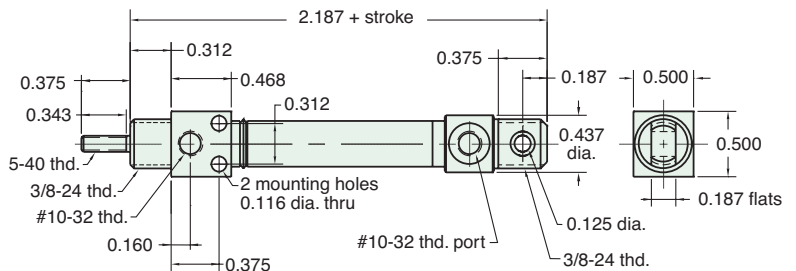

Nuts included, but not shown on drawing

5/16" BORE STAINLESS STEEL CYLINDER



SRR-05-□-□

Reverse Acting

Mount: Stud
Type: Rotating Rod
Options: B, V, N

Standard Stroke Lengths: 1/2", 1", 1-1/2", 2", 3", 4"
Spring Compressed: 1 lbs. **Spring At Rest:** 0.5 lbs.
Maximum Stroke: 17"

For B option add 0.250

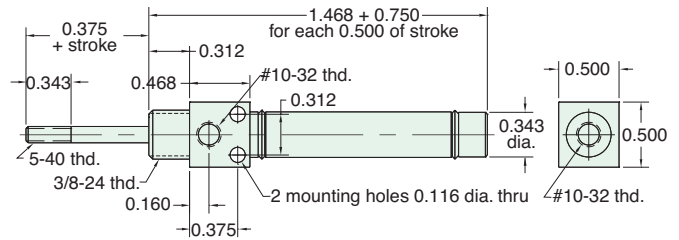

Nuts included, but not shown on drawing

URR-05-□-□

Reverse Acting

Mount: Universal
Type: Rotating Rod
Options: B, V, P2, P3, P4, P5, P6, P7, P8, N

Standard Stroke Lengths: 1/2", 1", 1-1/2", 2", 3", 4"
Spring Compressed: 1 lbs. **Spring At Rest:** 0.5 lbs.
Maximum Stroke: 17"

For B option add 0.250

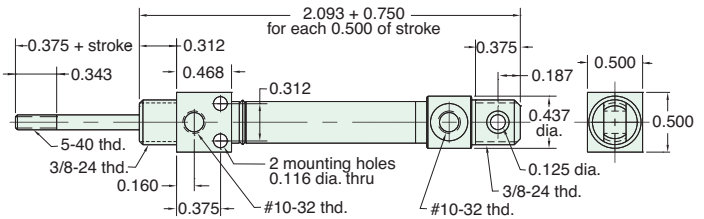

Nuts included, but not shown on drawing

FORCE FACTOR

The "force factor" is the nominal area of the cylinder bore size. The chart to the right provides theoretical forces in both the extend and retract stroke of all available bore sizes.

These values are theoretical and make no allowance for friction which varies with the bore size. It is recommended that a 25% safety factor be allowed when selecting a cylinder bore for normal load movement. In high speed applications that number should be at least 40%.

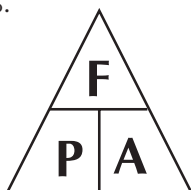

The extend and retract values differ due to the rod diameter.

Bore Size	1/2"	5/8"	3/4"	7/8"	1-1/16"	1-1/4"	1-1/2"	1-3/4"	2"	2-1/2"	3"	
Force Factor - Extend (area)	0.07	0.19	0.31	0.44	0.60	0.88	1.2	1.7	2.4	3.1	4.9	7.0
Force Factor - Retract (area)	0.06	0.16	0.28	0.39	0.55	0.80	1.09	1.55	2.2	2.9	4.59	6.56
20 psig - Extend (lbs)	1.4	3.8	6.2	8.8	12.0	17.6	24.0	34.0	48.0	62.0	98.0	140.0
20 psig - Retract (lbs)	1.16	3.25	5.65	7.82	11.02	16.07	21.79	31.0	44.07	58.07	91.86	131.16
50 psig - Extend (lbs)	3.5	9.5	15.5	22.0	30.0	44.0	60.0	85.0	120.0	155.0	245.0	350.0
50 psig - Retract (lbs)	2.9	8.13	14.13	19.55	27.55	40.17	54.48	77.5	110.18	145.18	229.66	327.91
80 psig - Extend (lbs)	5.6	15.2	24.8	35.2	48.0	70.4	96.0	136.0	192.0	248.0	392.0	560.0
80 psig - Retract (lbs)	4.64	13.0	22.6	31.27	44.07	64.26	87.17	124.0	176.29	232.29	367.46	524.66



5/16" BORE ACCESSORIES

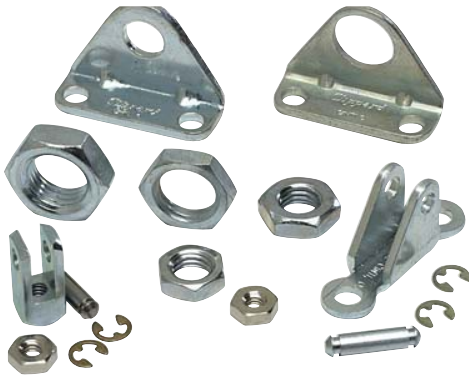

CB-0595

Clevis Bracket
Material: Steel, bright zinc plated

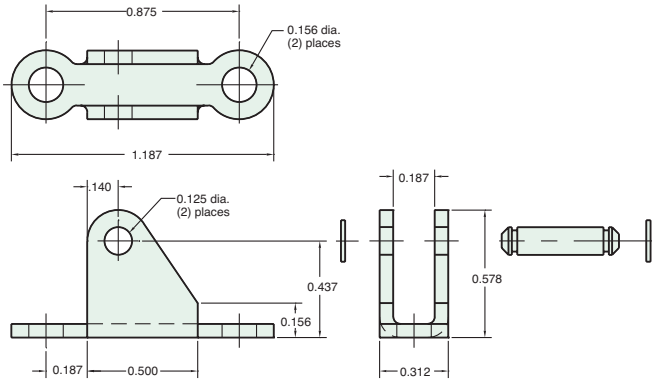

RC-0581

Rod Clevis
Material: Steel, electroless nickel plate

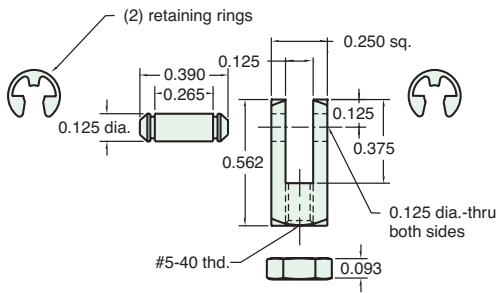

FB-0591

Foot Bracket
Material: Steel, bright zinc plated

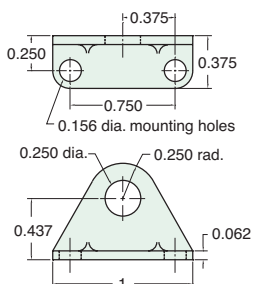

MOUNTING NUTS

Stud Nut

Part Number	Across Flats	Nut Thickness	Nut (Thread)
N04-28A	7/16"	5/32"	1/4-28
N04-28B	3/8"	1/8"	1/4-28
N06-24A	9/16"	7/32"	3/8-24
N06-24B	1/2"	1/8"	3/8-24

Rod Nut

Part Number	Across Flats	Nut Thickness	Nut (Thread)
N02-40	1/4"	3/32"	#5-40

RE-0585

Rod End
Material: Steel, bright zinc plated body

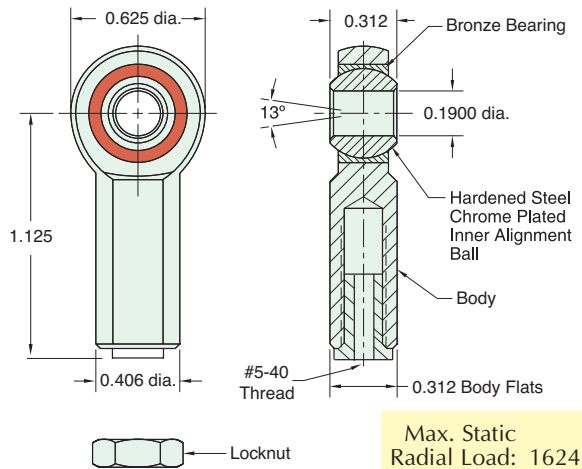

Max. Static Radial Load: 1624 lbs.
Fits Rod Thread Size: #5-40

FB-0592

Foot Bracket
Material: Steel, bright zinc plated

