



# 3/8" BORE BRASS MINIMATIC® CYLINDER

## 3SS-AR-1/2

**Mount:** Stud **Available Stroke Lengths:** 1/2"  
**Type:** Single Acting  
 Spring Extended

Add **-N** to the end of the part number for a non-threaded rod

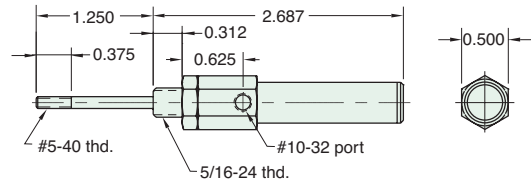

Rod nut included, but not shown on drawing

## 3PS-1/2

**Mount:** Body\* **Available Stroke Lengths:** 1/2"  
**Type:** Single Acting  
 Spring Return **Ports:** End or Side

Brass Rod - non-rotating

Add **-N** to the end of the part number for a non-threaded rod

\*Super Structure recommended

First Cylinder - 1949

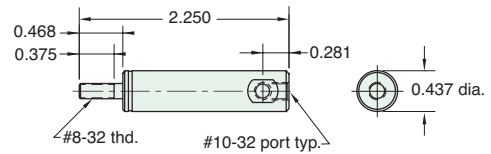

Rod nut included, but not shown on drawing

## 3SS-□

**Mount:** Stud **Stroke** 1/2" 1" 2" 3"  
**Type:** Single Acting  
 Spring Return **Length "L"** 2.093 3.343 5.218 7.093

**To order:** Add stroke length to the end of the part number

Add **-T** to the end of the part number after stroke for a #10-32 x 1/2" rod thread

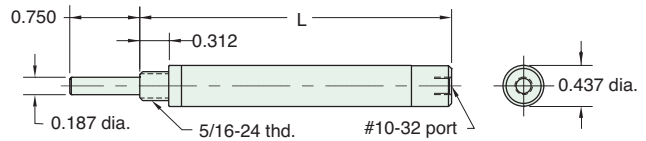

## 3CS-□

**Mount:** Clevis **Stroke** 1/2" 1" 2" 3"  
**Type:** Single Acting  
 Spring Return **Length "L"** 2.468 3.406 5.281 7.156

**To order:** Add stroke length to the end of the part number

Add **-T** to the end of the part number after stroke for a #10-32 x 1/2" rod thread

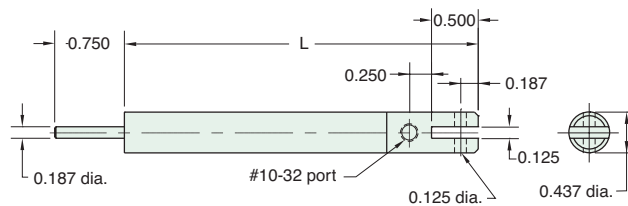

# 3/8" BORE BRASS MINIMATIC® CYLINDER



## 3BDS-□

**Mount:** Block      **Available Stroke Lengths:** 1", 2", 3", 4", 5", 6"

**Type:** Double Acting

**To order:** Add stroke length to the end of the part number

Add **-T** to the end of the part number after stroke for a #5-40 x 1/2" rod thread

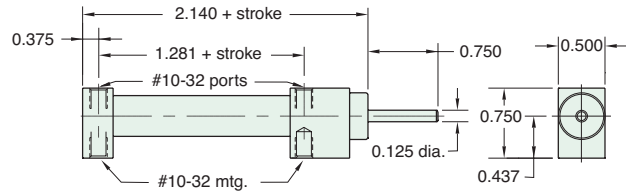

## 3BDD-□

**Mount:** Block      **Available Stroke Lengths:** 1", 2", 3", 4"

**Type:** Double Acting  
Double Rod

**To order:** Add stroke length to the end of the part number

Add **-T** to the end of the part number after stroke for a #5-40 x 1/2" rod thread

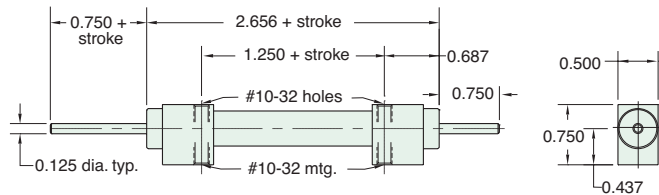

## 3SD-□

**Mount:** Stud      **Available Stroke Lengths:** 1", 2", 3", 4"

**Type:** Double Acting

**To order:** Add stroke length to the end of the part number

Add **-T** to the end of the part number after stroke for a #5-40 x 1/2" rod thread

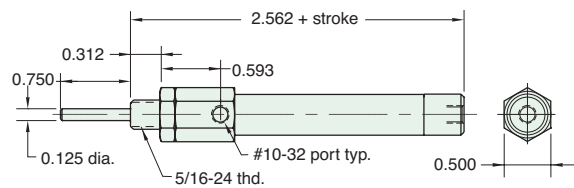

Nut included, but not shown on drawing

## 3CD-□

**Mount:** Clevis      **Available Stroke Lengths:** 1", 2", 3", 4"

**Type:** Double Acting

**To order:** Add stroke length to the end of the part number

Add **-T** to the end of the part number after stroke for a #5-40 x 1/2" rod thread

