



3-WAY AIR-PILOTED & LIMIT VALVES



3-Way Air-Piloted Valves

3-way valves have an inlet, outlet and exhaust port. When an air signal is applied to the pilot of a Normally-Closed (N.C.) valve the inlet is open to the outlet and the exhaust is blocked; removing the pilot closes the inlet and the outlet is open to the exhaust port which vents to atmosphere. When an air signal is applied to the pilot of a Normally-Open (N.O.) valve the inlet is blocked and the outlet is vented; removing the pilot signal opens the inlet to the outlet and blocks the exhaust.

Medium: Air only

Materials: Brass body, Buna-N seals, stainless steel stem and spring

Mounting: 5/8-32 thread or #4 screw. Nut and lockwasher may be ordered separately. Part Number: PAV-MH

Air Pilot Pressure: 15 psig min.

Foot Bracket: FB-1791

Air-Piloted N.C. Poppet Valves

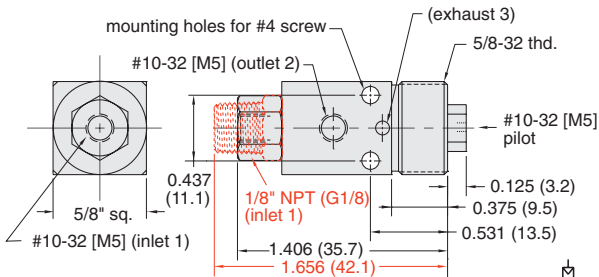

Input Pressure: 300 psig max.

Air Flow: 4.0 scfm @ 50 psig; 6.8 scfm @ 100 psig



Part No.	Description
PAV-3	Normally-Closed Poppet Valve, #10-32
PAV-3P	Normally-Closed Poppet Valve, 1/8" NPT

Air-Piloted N.O. Spool Valves

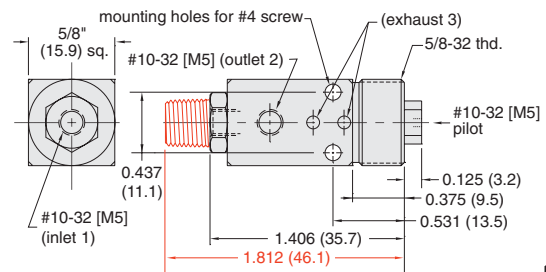
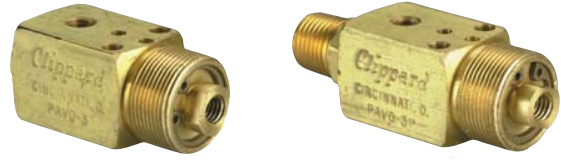

Input Pressure: 150 psig max.

Air Flow: 6.8 scfm @ 50 psig; 11.6 scfm @ 100 psig



Part No.	Description
PAVO-3	Normally-Open Spool Valve, #10-32
PAVO-3P	Normally-Open Spool Valve, 1/8" NPT

Miniature Limit Valve

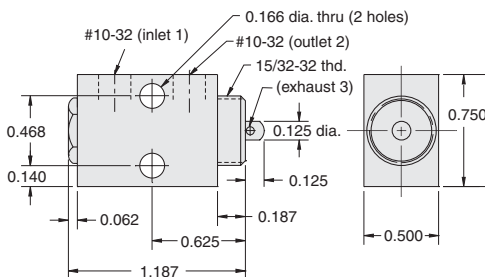

Stem Travel: 1/8"

Input Pressure: 150 psig max.

Air Flow: 4 scfm @ 50 psig; 7 scfm @ 100 psig

Force for Full Stem Travel: 48 oz. nominal

Mounting: Dual #20 holes or 15/32-32 thd. Nut and lockwasher furnished

Part No.	Description
MLV-3	Normally-Closed Miniature Limit Valve