

MINIMATIC® CONNECTOR FITTINGS



15453



Male #10-32 Coupling

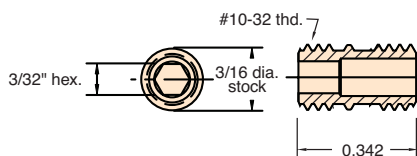

Material: Stainless steel

Thread: #10-32

Seals: Loctite necessary

Use: Excellent for a surface to surface connection of female #10-32 products

15010



#10-32 Extension Fitting

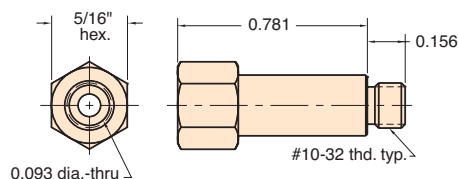

Material: Brass

Thread: #10-32

Gasket: Buna-N furnished

Use: To provide extension for convenience in assembling components

Options: (-ENP)



15004



#10-32 Female Hex Coupling

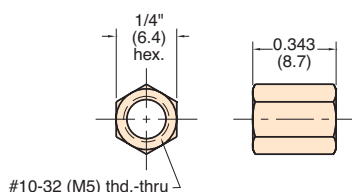

Material: Brass

Thread: #10-32 tapped (M5)

Use: For coupling two #10-32 (M5) male fittings

Options: (-M5), (-ENP)



11999



#10-32 Male Connector

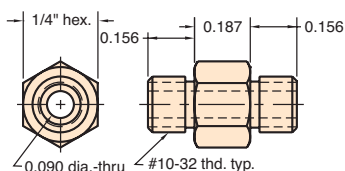

Material: Brass

Thread: #10-32 both ends

Gaskets: Buna-N 2 furnished

Use: For coupling cylinders directly to valves, and many other coupling arrangements

Options: (-ENP)



3810-1



1/8" NPT to 1/8" O.D. Tube Compression Fitting

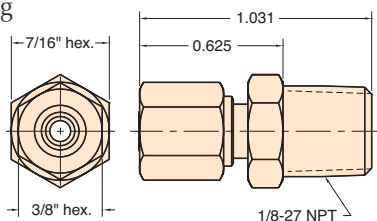

Material: Brass

Thread: 1/8" NPT

Use: Joins standard size pipe to 3811-1-RL copper or NYT1-0403-CLT nylon tubing

Replacement Ferrule & Nut: #15155

Options: (-ENP)

Features: One piece ferrule and nut for fast, easy insertion of tube



3810-2



1/16" NPT to 1/8" O.D. Tube Compression Fitting

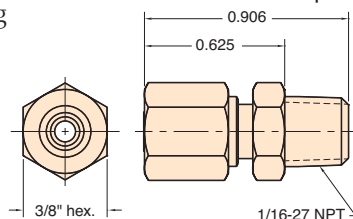

Material: Brass

Thread: 1/16" NPT

Use: Joins standard size pipe to 3811-1-RL copper or NYT1-0403-CLT nylon tubing

Replacement Ferrule & Nut: #15155

Options: (-ENP)

Features: One piece ferrule and nut for fast, easy insertion of tube

